

CONSTRUCTION BUCKET

BUILDING SITES HANDLING Solutions

ADVANTAGES

- Durable bucket designed for intensive use.
- Specially created for building sites and earthwork.
- Heavy duty structure that ensures excellent bucket longevity.
- Bucket fitted with teeth made for an easy and powerful penetration on earth.

TECHNICAL CHARACTERISTICS

- Wide range of bucket capacity from 650 L to 900 L.
- Construction bucket suitable for handling materials with a density $\leq 2,1$.
- Bucket equipped with dismountable teeth.

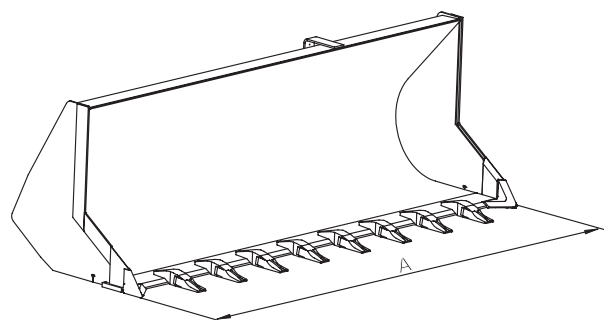
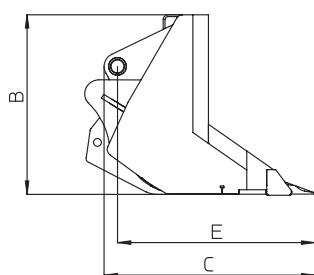
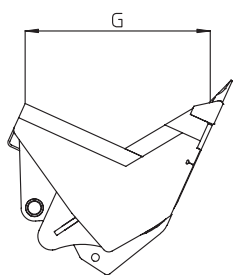

	Capacity (L)	A	B	C	E	G	Teeth	Weight (kg)
CBC 650L 1850	676	1850	810	1026	884	825	6	320
CBC 700L 1950	697	1950	810	1026	884	825	6	330
CBC 800L 2250	814	2250	810	1026	884	825	6	385
CBC 900L 2450	893	2450	810	1026	884	825	8	410

COMPATIBILITY*

	CBC 650L 1850	CBC 700L 1950	CBC 800L 2250	CBC 900L 2450
Part Number	654473	654472	654471	654470
MT 625	X			
MT 732		X	X	X
MT 835			X	X
MT 932			X	X
MT 1030			X	X
MT 1135				X
MT 1235			X	X
MT 1335				X
MT 1440			X	X
MT 1740			X	X
MT 1840			X	X

* This Attachment has been approved for the MT listed above. A load chart Machine/Attachment has been created accordingly.

This brochure describes versions and configuration options for Manitou products which may be fitted with different equipment. The equipment described in this brochure may be standard, optional or not available depending on version. Manitou reserves the right to change the specifications shown and described at any time and without prior warning. The manufacturer is not liable for the specifications given. For more information, contact your Manitou dealer. Non-contractual document.

Product descriptions may differ from actual products. List of specifications is not comprehensive. The logos and visual identity of the company are the property of Manitou and may not be used without authorisation. All rights reserved. The photos and diagrams contained in this brochure are provided for information only.

MANITOU BF SA - Limited company with board of directors - Share capital: 39,547,824 euros - 857 802 508 RCS Nantes

CBC_EN_B_0413



www.manitou.com